

Note : The pictures in the Product Specification are for reference only, please refer to the actual product.

PRODUCT SPECIFICATION

SILICONE NEON STRIP

- 360° Lighting

D13 360° Lighting
LED NEON LIGHT



www.aidiwatlighting.com



- It is made of Dow Chemical SILASTIC™ ET-7021 silicone rubber, which provides high transparency and high strength.
- Environmental protection grade silicone material, integrated extrusion molding process.
- Unique optical light distribution structure design, uniform lighting surface and no shadow.
- IP65 protection level, salt solution resistance, acids & alkalis and UV resistance.
- Excellent toughness, simple and stylish appearance, delicate and unique.
- 5 years warranty, working life ≥ 50000 hours.

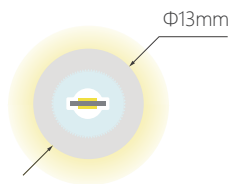

Diameter

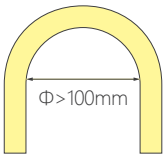

Minimum bending diameter

Front entry Integral End cap (IP65)

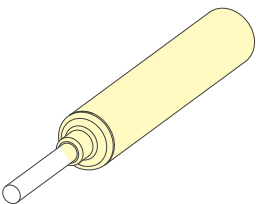
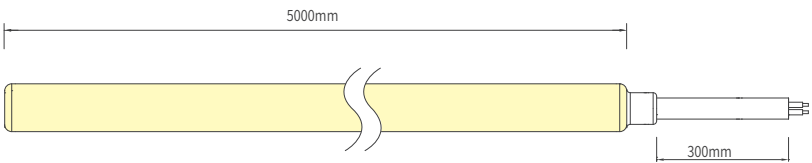

Cable entry: Front

Electrical Parameter

Voltage	DC24V
LED PIN Temperature	Max. 65 °C
Storage Temperature	-25 °C ~ 60 °C
Ambient Temperature	Min. -25°C, Max (Table below)
RA	≥ 90

Specification

Power(w/m)	Min :3W/M; Max :10 W/M
Efficacy(lm/w)@4000K	61.7lm/w
Working Temperature	-25 °C ~ 45 °C

Due to the tolerance of the production and electrical components, output value and electrical power can vary up to 10%.

Light Distribution Curve

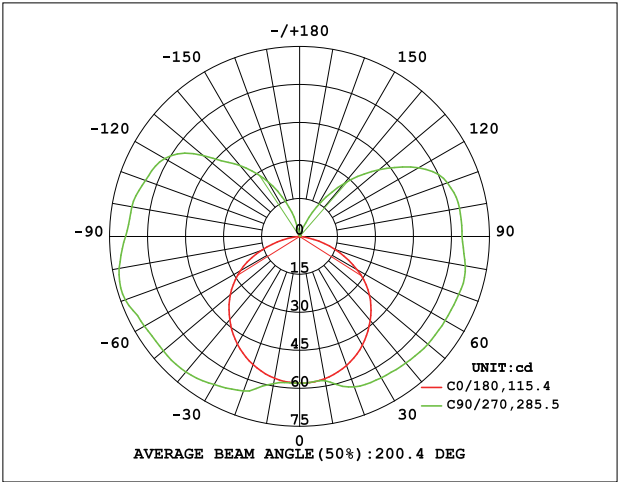

Illuminance curve

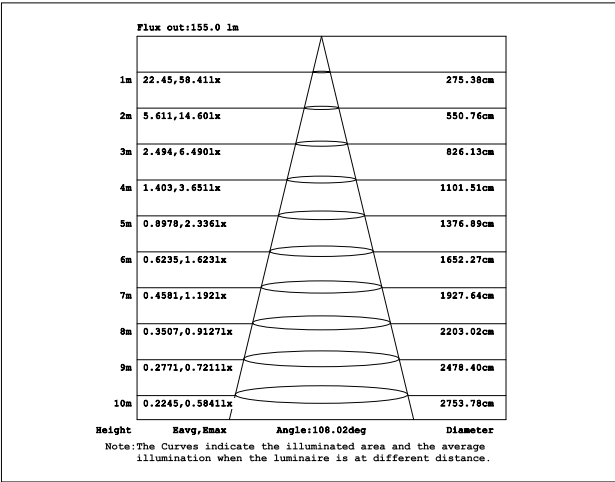

Note: The above data is based on 24V ,10W/M, single colour with 4000k colour temperature. If you need IES files for other types. Please contact our sales department.



- The maximum series length refers to the maximum single end power supply length of the constant current strip under the condition of standard 30cm wire .
- The given color temperature is the temperature of finished product.
- The given data are typical values due to the tolerances of the production process and the electrical components, values for light output and electrical power can vary up to 10%.

Single color

CCT(K)	RA	Voltage	Power(W)	Lumen (LM/M)	Efficiency (LM/W)	Unit Length (mm)	Max.Run Length (M)	CC/CV
1800±100	≥90	DC24V	8.6	385	44.7	25	5	CV
2400±150	≥90	DC24V	8.6	461	53.6	25	5	CV
2700±150	≥90	DC24V	8.6	514	59.8	25	5	CV
3000±150	≥90	DC24V	8.6	518	60.2	25	5	CV
3500±200	≥90	DC24V	8.6	506	58.8	25	5	CV
4000±300	≥90	DC24V	8.6	531	61.7	25	5	CV
5200±400	≥90	DC24V	8.6	500	58.1	25	5	CV
6500±400	≥90	DC24V	8.6	489	56.9	25	5	CV
Red	--	DC24V	8.6	55	6.4	25	5	CV
Green	--	DC24V	8.6	599	69.6	25	5	CV
Blue	--	DC24V	8.6	115	13.3	25	5	CV
Yellow	--	DC24V	8.6	93	10.8	25	5	CV
Orange	--	DC24V	8.6	101	11.7	25	5	CV

Various End Caps

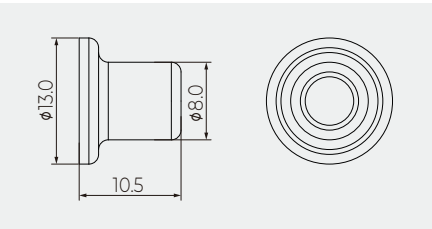

Integral end cap

Cable Lead Option

Front Cable Entry



Front Cable Entry



Closed End cap

Note:The pictures in the Product Specification are for reference only, please refer to the actual product.

Cable Type

Cable Type	Schematic Diagram	Specification	Core	Electrical Properties
------------	-------------------	---------------	------	-----------------------

PVA Cable		OD: 5.0mm / Inner core: 20AWG		Red V+, Black V-
-----------	--	-------------------------------	--	------------------

Mounting Way

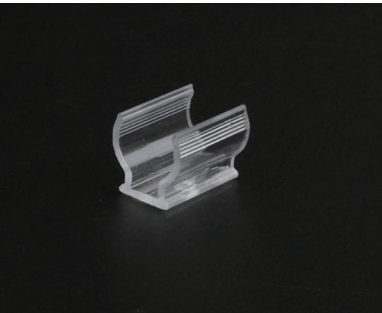

PC clips
20x10.5x13.7mm(L x W x H)
Accessories:Screw M3x15mm

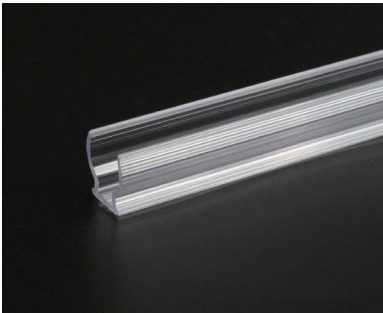
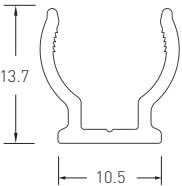

PC Profile
1000(±5)x10.5x13.7mm(L x W x H)
Accessories:Screw M3x15mm

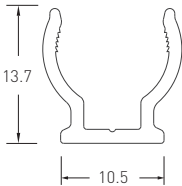

Single Color Connection Diagram

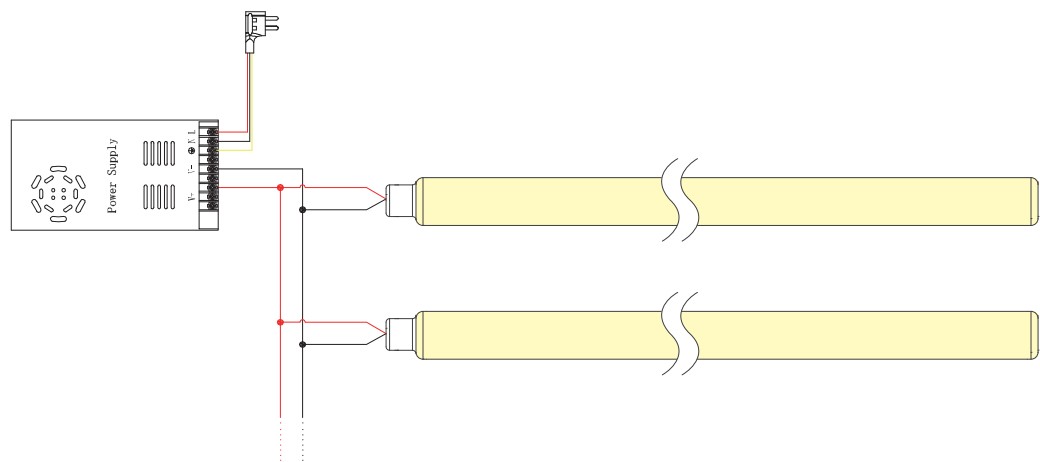

Notes

The selection of the cable specification at the output end of the power supply, it depends on the total current of the load and the length of the cable. It is recommended to select according to the following table:

Current of the light	Specifications of the cable								
	L=1M	L=2M	L=4M	L=6M	L=8M	L=10M	L=12M	L=14M	L=16M
1A	AWG26	AWG23	AWG21	AWG18	AWG18	AWG17	AWG16	AWG15	AWG15
2A	AWG23	AWG21	AWG18	AWG16	AWG15	AWG14	AWG13	AWG12	AWG12
3A	AWG22	AWG18	AWG16	AWG14	AWG13	AWG12	AWG11	AWG11	AWG10
4A	AWG21	AWG18	AWG15	AWG13	AWG12	AWG11	AWG10	AWG9	AWG9
5A	AWG20	AWG17	AWG14	AWG12	AWG11	AWG10	AWG9	AWG9	AWG8
6A	AWG18	AWG16	AWG13	AWG11	AWG10	AWG9	AWG8	AWG8	AWG7
7A	AWG18	AWG15	AWG12	AWG11	AWG9	AWG8	AWG8	AWG7	AWG6
8A	AWG17	AWG15	AWG12	AWG10	AWG9	AWG8	AWG7	AWG7	AWG6
9A	AWG17	AWG14	AWG11	AWG10	AWG8	AWG7	AWG7	AWG6	AWG5
10A	AWG16	AWG14	AWG11	AWG9	AWG8	AWG7	AWG6	AWG6	AWG5

Notes

- ※ The unused light should be sealed with the packaging bag to avoid prolonged exposure.
- ※ Please use DC24V isolated constant voltage power supply with ripple voltage less than 5%. Using other types of power supply may damage the light or cause other safety risks.
- ※ In practical application, 20% allowance should be reserved for power supply to ensure the stability of power supply.
- ※ It is recommended that professionals connect the power supply. Do not connect the power supply with live power to avoid electric shock.
- ※ Please confirm whether the voltage of the power supply is consistent with the voltage of the light; Pay attention to the positive and negative poles of the power cord, do not connect wrong, so as not to cause product damage;
- ※ When multiple power supplies are used, ensure that the positive poles of the power supply are not connected in parallel. Otherwise, the power supply system may be unstable or damaged after long-term operation.
- ※ If the actual application length exceeds the specified length, it will lead to overload, heating and uneven brightness of the light.
- ※ During installation, please do not scratch, twist, or bend the light irregularly. Otherwise, the light may be damaged beyond repair.
- ※ To ensure the life and reliability of the light, please do not over bend the light, which will damage the product itself.
- ※ To protect your eyes, please avoid staring at the glowing surface of the light for a long time.
- ※ Non-professionals are forbidden to install, disassemble and maintain the product.
- ※ Do not use any acid or alkaline adhesive to fix the light (including but not limited to glass glue, etc.)
- ※ IP67 products are not suitable for long-term immersion in water; IP68 products are only customized by the factory. After cutting and processing by users themselves, there is a risk that IP68 protection level cannot be reached
- ※ Because of the difference in structure, even if the same color temperature value, different sizes of light will look slightly different colors. Please confirm it before use.

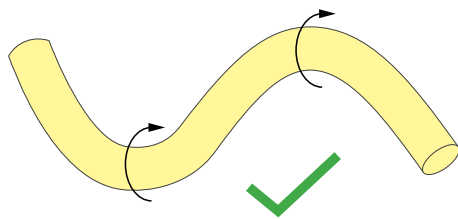

Min Bending diameter $\geq 100\text{mm}$

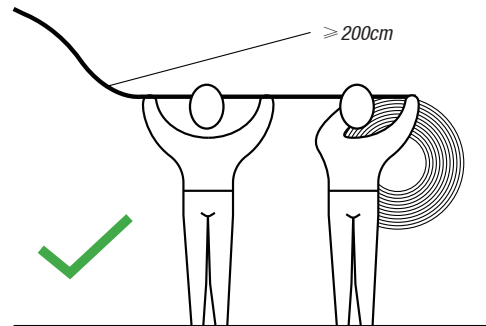

If the length of the light is more than 2 meters,
two persons must work together to install it.

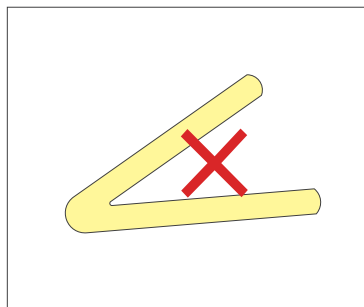

Small Angle bending
is prohibited

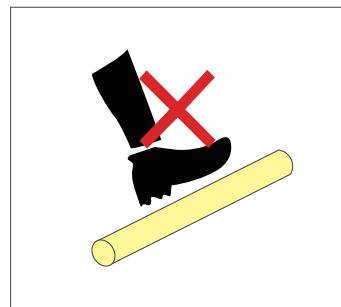

Prohibit trample

Tests showed that methanol and benzenes will have yellowing effects on silicone.

In the newly decorated interior environment, epoxy floor paint, wall paint, wallpaper adhesive, various decoration materials or new furniture, they are likely to release of methanol and benzenes.

It is recommended to remove methanol and benzenes first, or ventilate for a period of time in the newly decorated interior environment before install the silicone neon light, to avoid affecting the silicone body.